

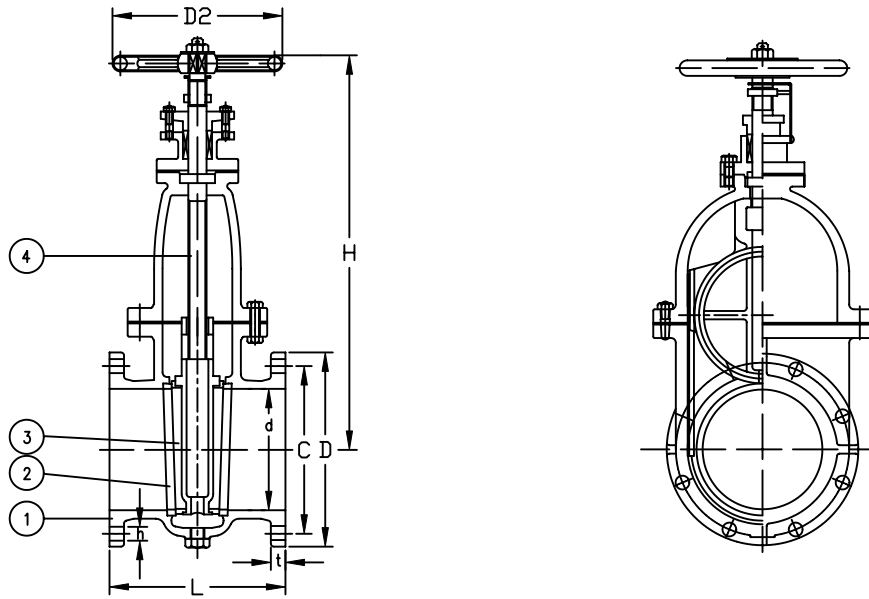

Class 150 Bronze NRS Gate Valve

Bolted Bonnet - Non Rising Stem

Series 1021 ... Regular



Face to face acc. to ANSI B16.10
Flanges acc. to ANSI B16.24 Class 150

Part Nr.	Material (Option 1)	Material (Option 2)	Hydraulic Inspection	
			Shell	Seat
1 - Body	Bronze - B62	Bronze - B62	350 PSIG	225 PSIG
2 - Seat Ring	Bronze - B62	St. Steel - SS304		
3 - Disc Ring	Bronze - B62	St. Steel - SS304		
4 - Stem	Brass - B124	Brass - B124		

	Size	L	D	C	n	h	t	H	D2	Lb Kg
in	2	7.00	6.00	4.75	4	0.75	0.50	11.25	5.00	32
mm	50	178	152	121		19	13	286	127	15
in	2.50	7.50	7.00	5.50	4	0.75	0.56	13.00	5.50	44
mm	65	191	178	140		19	14	330	140	20
in	3	8.00	7.50	6.00	4	0.75	0.62	13.00	6.31	53
mm	80	203	191	152		19	16	330	160	24
in	4	9.00	9.00	7.50	8	0.75	0.68	17.00	7.12	84
mm	100	229	229	191		19	17	432	181	38
in	5	10.00	10.00	8.50	8	0.88	0.75	19.50	7.88	114
mm	125	254	254	216		22	19	495	200	52
in	6	10.50	11.00	9.50	8	0.88	0.80	22.00	8.88	154
mm	150	267	279	241		22	20	559	225	70
in	8	11.50	13.50	11.75	8	0.88	0.94	26.75	11.00	268
mm	200	292	343	298		22	24	679	279	122
in	10	13.00	16.00	14.25	12	1.00	1.00	31.50	14.00	420
mm	250	330	406	362		25	25	800	356	191
in	12	14.00	19.00	17.00	12	1.00	1.06	33.25	15.00	636
mm	300	356	483	432		25	27	845	381	289



Class 150 Bronze Globe Valve Bolted Bonnet - OS&Y

Series 2021 ... Regular
Series 2121 ... SDNR

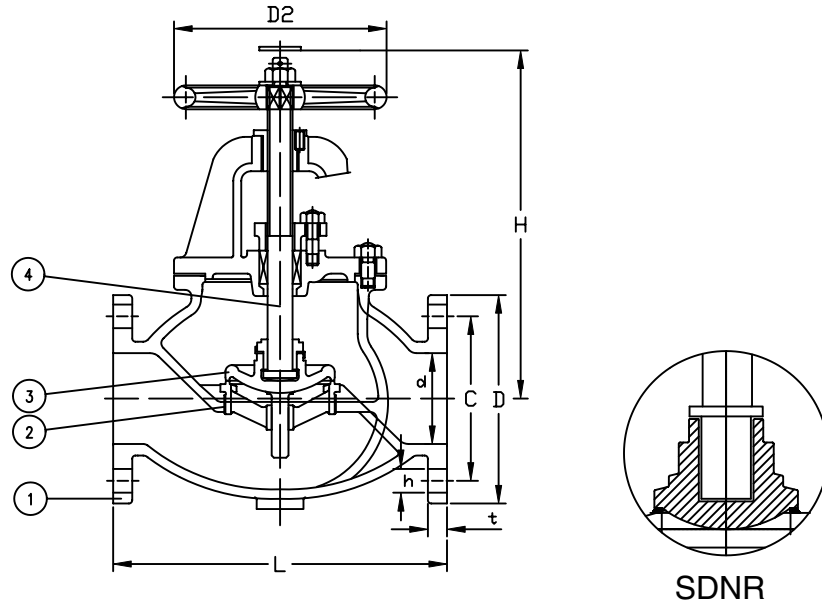

Face to face acc. to ANSI B16.10
Flanges acc. to ANSI B16.24 Class 150

Part Nr.	Material (Option 1)	Material (Option 2)	Hydraulic Inspection	
			Shell	Seat
1 - Body	Bronze - B62	Bronze - B62	350 PSIG	225 PSIG
2 - Seat Ring	Bronze - B62	St. Steel - SS304		
3 - Disc Ring	Bronze - B62	St. Steel - SS304		
4 - Stem	Brass - B124	Brass - B124		

	Size	L	D	C	n	h	t	H	D2	Lb Kg
in mm	1.5 40	6.50 165	5.00 127	3.88 99	4	0.63 16	0.44 11	9.00 229	5.00 127	15 7
in mm	2 50	8.00 203	6.00 152	4.75 121	4	0.75 19	0.50 13	11.12 282	6.00 152	24 11
in mm	2.5 65	8.50 216	7.00 178	5.50 140	4	0.75 19	0.56 14	12.00 305	7.50 191	37 17
in mm	3 80	9.50 241	7.50 191	6.00 152	4	0.75 19	0.63 16	14.75 375	8.75 222	51 23
in mm	4 100	11.50 292	9.00 229	7.50 191	8	0.75 19	0.69 18	15.38 391	9.00 229	88 40
in mm	5 125	14.00 356	10.00 254	8.50 216	8	0.88 22	0.75 19	18.25 464	10.00 254	123 56
in mm	6 150	16.00 406	11.00 279	9.50 241	8	0.88 22	0.81 21	21.50 546	12.00 305	183 83
in mm	8 200	19.50 495	13.50 343	11.75 298	8	0.88 22	0.94 24	27.25 692	14.00 356	275 125



Class 150 Bronze Angle Valve

Bolted Bonnet - OS&Y

Series 3021 ... Regular
Series 3121 ... SDNR

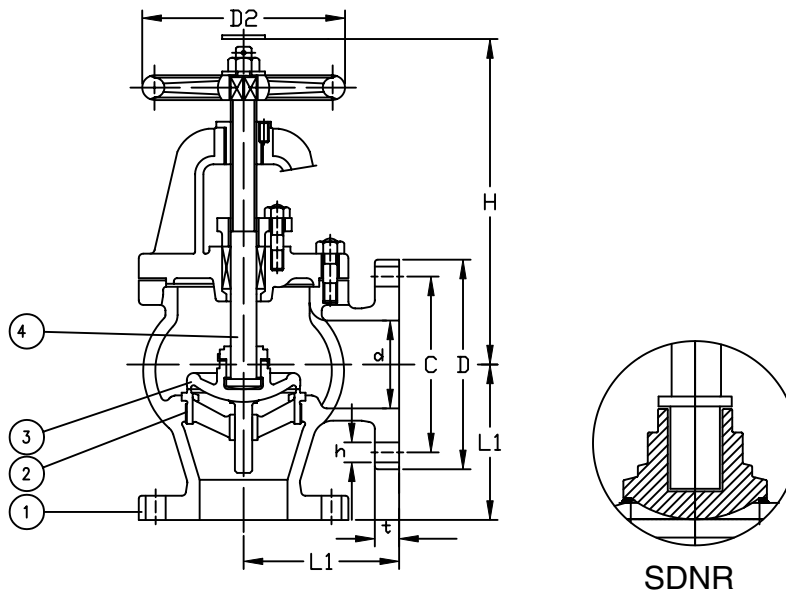

Face to center acc. to ANSI B16.10
Flanges acc. to ANSI B16.24 Class 150

Part Nr.	Material (Option 1)	Material (Option 2)	Hydraulic Inspection	
			Shell	Seat
1 - Body	Bronze - B62	Bronze - B62	350 PSIG	225 PSIG
2 - Seat Ring	Bronze - B62	St. Steel - SS304		
3 - Disc Ring	Bronze - B62	St. Steel - SS304		
4 - Stem	Brass - B124	Brass - B124		

	Size	L	D	C	n	h	t	H	D2	Lb Kg
in mm	1.5 40	3.25 83	5.00 127	3.88 99	4	0.63 16	0.44 11	9.00 229	5.00 127	22 10
in mm	2 50	4.00 102	6.00 152	4.75 121	4	0.75 19	0.50 13	11.12 282	6.00 152	33 15
in mm	2.5 65	4.25 108	7.00 178	5.50 140	4	0.75 19	0.56 14	12.00 305	7.50 191	44 20
in mm	3 80	4.75 121	7.50 191	6.00 152	4	0.75 19	0.63 16	14.75 375	8.75 222	44 24
in mm	4 100	5.75 146	9.00 229	7.50 191	4	0.75 19	0.69 18	15.38 391	9.00 229	84 38
in mm	5 125	7.00 178	10.00 254	8.50 216	8	0.75 19	0.75 19	18.25 464	10.00 254	114 52
in mm	6 150	8.00 203	11.00 279	9.50 241	8	0.88 22	0.81 21	21.50 546	12.00 305	154 70
in mm	8 200	9.00 229	13.50 343	11.75 298	8	0.88 22	0.94 24	27.25 692	14.00 356	266 121

Series 4421 ... Swing Check

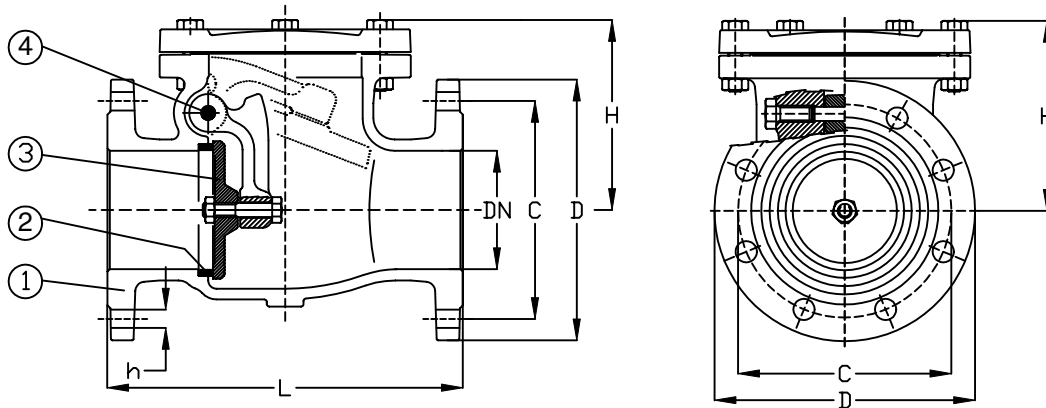

Face to face acc. to ANSI B16.10
Flanges acc. to ANSI B16.24 Class 150

Part Nr.	Material		Hydraulic Inspection			
	(Option 1)		(Option 2)			
1 - Body	Bronze	- B62	Bronze	- B62	Shell	350 PSIG
2 - Seat Ring	Bronze	- B62	St. Steel	- SS304		
3 - Disc Ring	Bronze	- B62	St. Steel	- SS304	Seat	225 PSIG
4 - Hinge	Brass	- B124	Brass	- B124		

	Size	L	D	C	n	h	t	H	Lb Kg
in mm	2 50	8.00 203	6.00 152	4.75 121	4	0.75 19	0.50 13	5.50 140	42 19
in mm	2.50 65	8.50 216	7.00 178	5.50 140	4	0.75 19	0.56 14	6.00 152	51 23
in mm	3 80	9.50 241	7.50 191	6.00 152	4	0.75 19	0.62 16	6.50 165	73 33
in mm	4 100	11.50 292	9.00 229	7.50 191	8	0.75 19	0.68 17	7.88 200	106 48
in mm	5 125	13.00 330	10.00 254	8.50 216	8	0.88 22	0.75 19	8.38 213	185 84
in mm	6 150	14.00 356	11.00 279	9.50 241	8	0.88 22	0.80 20	9.50 241	330 150
in mm	8 200	19.50 495	13.50 343	11.75 298	8	0.88 22	0.94 24	10.50 267	484 220
in mm	10 250	24.50 622	16.00 406	14.25 362	12	1.00 25	1.00 25	13.38 340	704 320
in mm	12 300	27.50 698	19.00 483	17.00 432	12	1.00 25	1.06 27	15.35 390	913 415

Series 7334G ... Globe
Series 7334A ... Angle

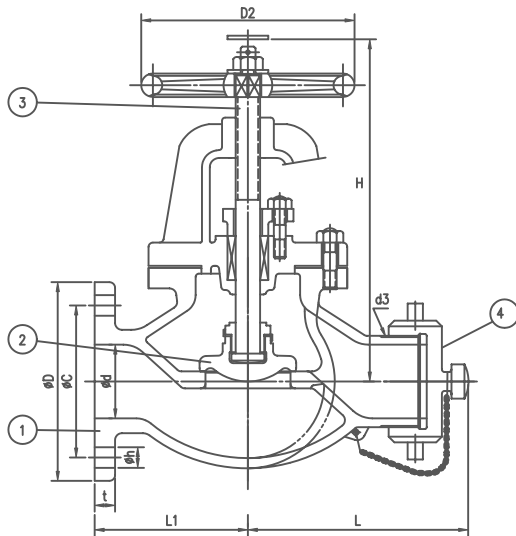

Globe Pattern

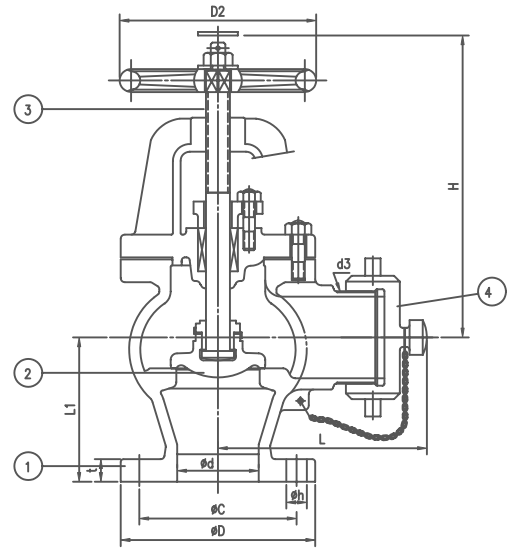

Angle Pattern

Flanges acc. to ANSI B16.24 Class 150
Other thread connections available upon request

Part Nr.	Material (Option 1)	Material (Option 2)	Hydraulic Inspection	
			Shell	Seat
1 - Body	Bronze - B62	Bronze - B62	350 PSIG	225 PSIG
2 - Disc	Bronze - B62	SS304 - SS304		
3 - Stem	Brass - B124	SS304 - SS304		
4 - Cap	Bronze - B62	Bronze - B62		

			Size	L	L1	D	C	n	h	t	H	D2	D3
Globe Pattern	Class 150#	in	1.5	4.13	3.54	5.00	3.88	4	0.63	0.44	7.48	5.51	9.5 NH
		mm	40	105	90	127	99		16	11	190	140	(NST)
	Class 300#	in	2	5.50	4.33	6.00	4.75	4	0.75	0.50	10.63	6.30	8 NH
		mm	50	140	110	152	121		19	13	270	160	(NST)
Angle Pattern	Class 150#	in	2.5	6.50	5.31	7.00	5.50	4	0.75	0.56	11.61	7.87	7 NH
		mm	65	165	135	178	140		19	14	295	200	(NST)
	Class 300#	in	2.5	7.00	5.70	7.50	6.00	8	.90	0.81	12.00	7.87	7 NH
		mm	65	178	145	190	152		23	20	305	200	(NST)
Globe Pattern	Class 150#	in	1.5	3.74	3.94	5.00	3.88	4	0.63	0.44	6.50	5.51	9.5 NH
		mm	40	95	100	127	99		16	11	165	140	(NST)
	Class 300#	in	2	5.12	4.72	6.00	4.75	4	0.75	0.50	9.45	6.30	8 NH
		mm	50	130	120	152	121		19	13	240	160	(NST)
Angle Pattern	Class 150#	in	2.5	6.50	5.12	7.00	5.50	4	0.75	0.56	10.04	7.87	7 NH
		mm	65	165	130	178	140		19	14	255	200	(NST)
	Class 300#	in	2.5	7.00	5.60	7.50	6.00	8	.90	0.81	11.50	7.87	7 NH
		mm	65	178	142	190	152		23	20	270	200	(NST)

Size 1.5" (40mm) will be supplied with a Screwed Bonnet (not pictured)